

## SEATING CAPACITY / DIMENSIONS

FUNCTION ROOM	LEVEL	DIMENSION (m X m)	COCKTAIL	BANQUET SIT-DOWN	THEATRE	CLASSROOM	U-SHAPE	HOLLOW SQUARE	BOARDROOM
Pacific B/room I	6	8 X 15	240	100	100	60	40	45	45
Pacific B/room II	6	16 X 15	320	150	200	120	60	60	60
Pacific B/room III	6	8 X 15	240	100	110	60	40	45	45
Pacific B/room I & II / II & III	6	24 X 15	500	200	300	180	70	90	90
Pacific B/room I,II & III	6	32 X 15	700	350	550	280	100	120	120
Pacific B/room Foyer	6	24 X 12	600	-	-	-	-	-	-
Straits Room I	7	9 X 11	80	60	80	50	30	36	36
Straits Room II	7	8 X 11	60	50	60	40	24	36	36
Straits Room III	7	8 X 11	60	50	60	40	24	36	36
Straits Room IV	7	8 X 11	60	50	60	40	24	36	36
Straits Room V	7	8 X 11	60	50	60	40	24	36	36
Straits Room VI	7	8 X 11	50	50	60	40	15	20	20
Straits Room III & IV / IV & V	7	16 X 11	140	100	120	70	42	60	60
Straits Room III, IV & V	7	24 X 11	180	200	200	110	65	84	84
Straits Board Room	7	8 X 6	20	20	20	20	10	10	10

## RECREATION FACILITIES

Rooftop swimming pool • Gymnasium • Optional tours

## OTHER FACILITIES & SERVICES

Airport transfer • Car rental • Car park • Internet access • Laundry and dry cleaning services • Business centre • Free shuttle service to tourist destinations and shopping malls

## CONTACT US

Hotel Address

146 Jalan Hang Tuah, 75300 Malacca, Malaysia.

T 606 281 6868

F 606 281 9898

W [www.avillionlegacymelaka.com](http://www.avillionlegacymelaka.com) GPS Coordinates: N +02°12'26, E +102°14'44

Kuala Lumpur Sales Office

E-3-1 Southgate Commercial Centre, Jalan Dua Off Jalan Chan Sow Lin, 55200 Kuala Lumpur, Malaysia.

T 603 2170 2115 F 603 2730 9959 W [www.avillionlegacymelaka.com](http://www.avillionlegacymelaka.com)

Avillion Central Reservation

T 603 2730 9988 F 603 2730 9998 E [res@avillionlegacymelaka.com](mailto:res@avillionlegacymelaka.com)

## ABOUT US

Located in the historical town of Malacca, Avillion Legacy Melaka is a boutique hotel with 228 tastefully furnished rooms. With its proximity to Kuala Lumpur city and Singapore, the hotel is a perfect venue for business and leisure getaways for urbanites.

Its Colonial-influenced architecture is complemented by an impressive glass dome in the lobby that has won many hearts, surpassing each and every guest's expectation.

## DESTINATION

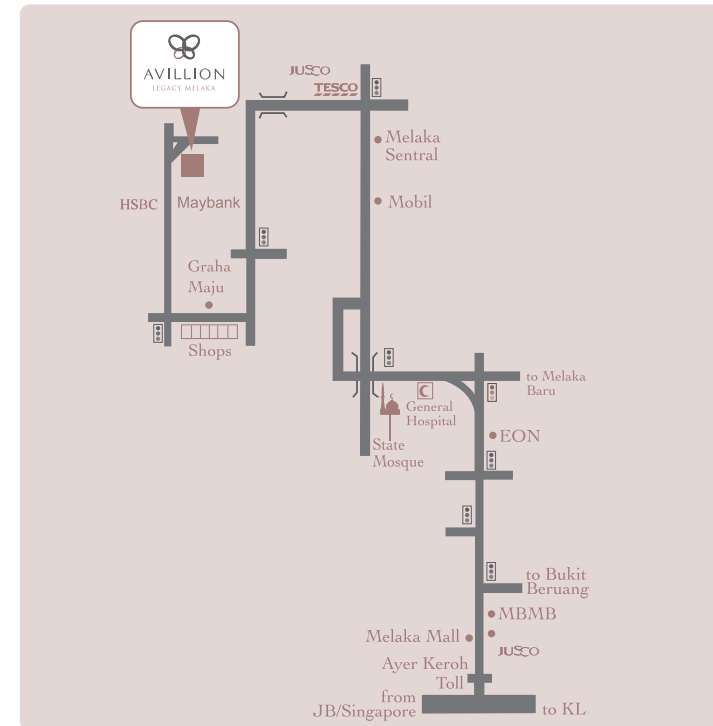

## TRANSPORTATION

Kuala Lumpur City	2 hour (150 km)
Kuala Lumpur International Airport	1 hour 30 minutes (120 km)
Tampin Railway Station	45 minutes (40 km)
Singapore	3 hours (220 km)

**STAY**  
Well-appointed and fully-furnished with little touches to make every guest feels at home, our rooms are categorized into Superior, Studio, Premium Studio and Suite categories.

**ROOM FACILITIES**

- King sized or twin beds
- Ensuite bathroom with long bath
- Premium guest amenities
- Air-conditioning
- Plasma TV with ASTRO channels
- Coffee & tea making facilities
- Mini bar
- Writing desk & chair
- In-room safe
- Hair dryer
- IDD telephone
- Iron & ironing board
- Electronic keycard security system
- 24-hour room service
- Daily newspaper
- Slippers
- Bathrobes (Premium Studio & Suite only)

ROOM TYPE	FLOOR AREA	TWIN BED	KING BED	TOTAL ROOMS
Superior	31.65 m <sup>2</sup>	119 units	65 units	184 units
Studio	51.17 m <sup>2</sup>	N/A	19 units	19 units
Premium Studio	54.27 m <sup>2</sup>	N/A	21 units	21 units
Suite	55.83 m <sup>2</sup>	N/A	4 units	4 units

**FOOD & BEVERAGE FACILITIES**

**Coffee House**  
Opens daily from 0700 hours to 2300 hours • Casual dining • Daily buffet breakfast • Continental and local cuisines • Free WiFi

**The Lounge**  
Opens daily from 1700 hours to 0100 hours • Serves snacks and beverages • Free WiFi

**Room Service**  
Available 24 hours

**BANQUETS & EVENTS**

Corporate Retreats / Meetings  
The hotel showcases a grand chandelier-lit ballroom that hosts up to 400 guests. In addition, there are 6 meeting rooms fully-equipped with state-of-the-art facilities along with meeting packages that are readily available for your convenience.

**Wedding Celebration**  
Chinese banquets or romantic poolside BBQ.

Kindly contact our Kuala Lumpur Sales Office for meeting or wedding arrangements.

Pacific Ballroom, Level 6

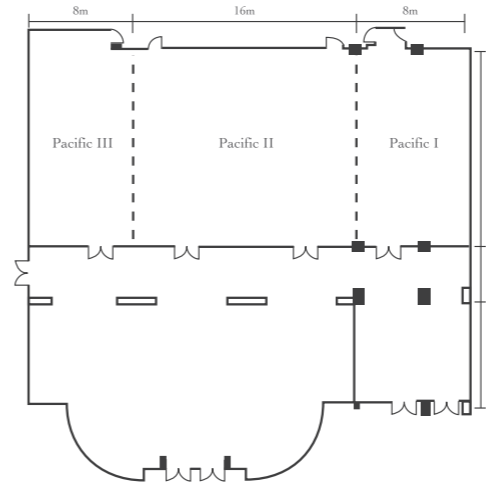

Peninsular Room I & II, level 6

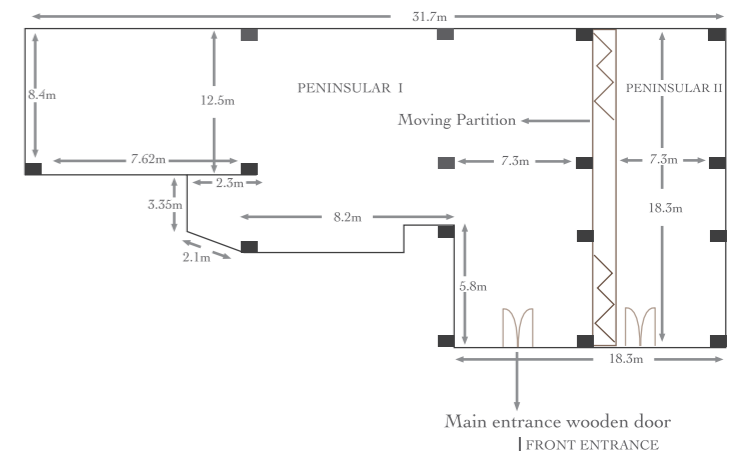

Straits Function Rooms, Level 7

